

PROPOSED STAGE 4 TRAFFIC SWITCH US 17 BYPASS SB ONTO SB RAMPS C AND D

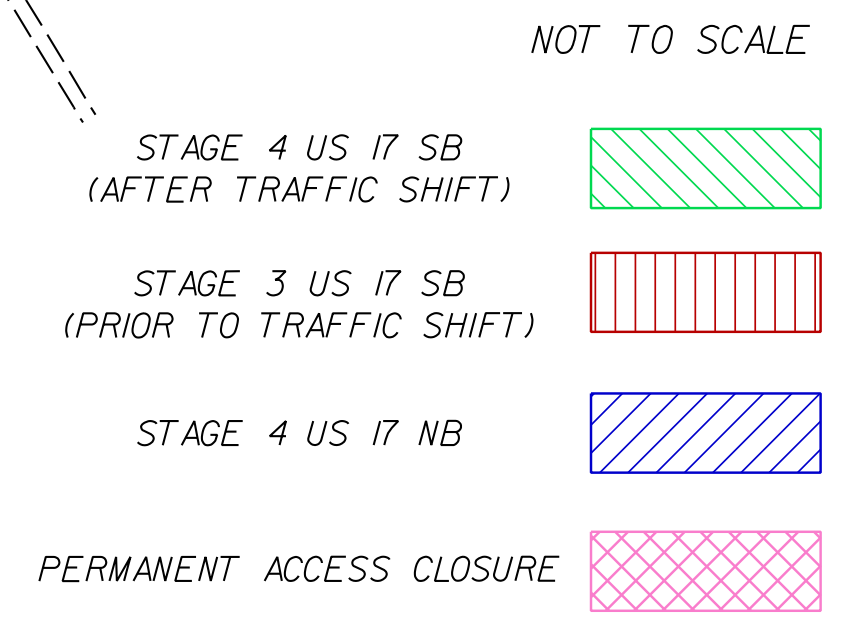
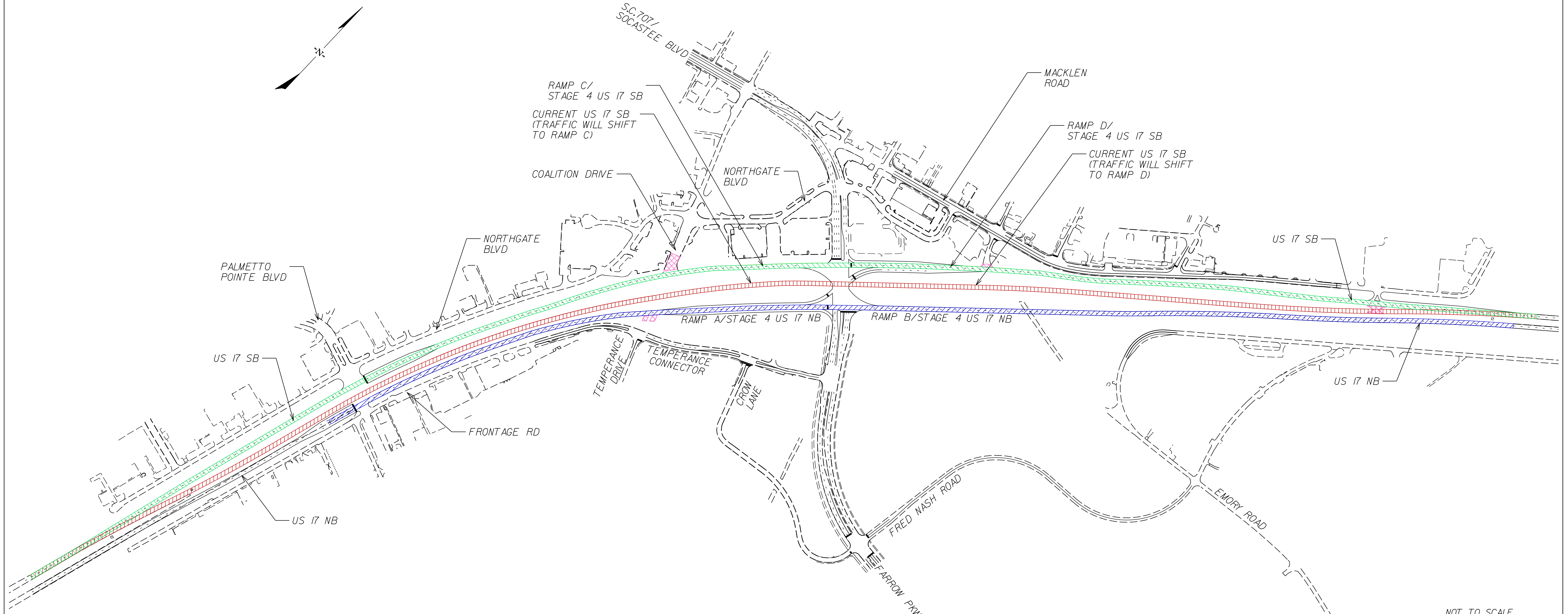

NOTE:
CHANGEABLE MESSAGE SIGNS SHALL BE UTILIZED AND PLACED IN A LOCATION AS TO PROPERLY PREPARE DRIVERS FOR THE PROPOSED TRAFFIC SHIFT.
REFER TO PLAN SET SHEET TC-1/I FOR PROJECT REQUIREMENTS.

FOR INFORMATION ONLY

STV Incorporated
 ROCK HILL BUSINESS TECHNOLOGY CENTER, BTC 517
 454 S. ANDERSON ROAD, SUITE 3
 ROCK HILL, SOUTH CAROLINA 29730

SOUTH CAROLINA
 DEPARTMENT OF TRANSPORTATION
 ROAD DESIGN COLUMBIA, S.C.

**INTERCHANGE AT US 17 BYPASS
 AND SC 707 / FARROW PARKWAY
 US 17 SB TRAFFIC SWITCH
 ONTO SB RAMPS C AND D**

SCALE 1"=NTS RTE. US 17 BYPASS DWG.NO. PN1