Public Information Office

Contact: Lisa H. Bourcier, PIO
Post Office Box #1236
Conway, SC 29528
E-mail: bourcier@horrycounty.org

Phone: 843-915-5390
Fax: 843-915-6390
www.horrycounty.org

.....
ATTENTION!
.....

US17 Bypass/SC707 Interchange
Construction Milestone

Conway, South Carolina – Motorists along the Grand Strand will see the first major traffic milestone on the US17 Bypass/SC707 Interchange Project. The following changes will occur:

May 29, 2012

- Beginning Tuesday, May 29, the following intersections at US RT 17 Bypass will be closed permanently: Ranchette Circle and Coalition Drive. Access to US RT 17 Bypass will not be allowed (northbound or southbound). This traffic change has been a part of the original project.
- Access from southbound US RT 17 Bypass to Port Drive (near Jamin' Leather) will be a right-in, right-out directly onto US RT 17 Bypass (no access from Port Drive to northbound US RT 17 Bypass will be allowed). This traffic change has been a part of the original project.

June 1 & 2, 2012 (Weather permitting)

- Beginning Friday, June 1 (approximately 8pm), all northbound traffic at the interchange will be switched onto Ramps A & B on the east side of US RT 17 Bypass. This traffic shift will remain in place for approximately two years.
- Beginning on Saturday, June 2, at 7 a.m. until Sunday, June 3, around 9 a.m., no left hand turns will be allowed from US RT 17 Bypass at its intersection with SC RT 707 and Farrow Parkway. This temporary traffic

adjustment is necessary to relocate the overhead traffic lights at the intersection and make necessary asphalt tie-ins for the traffic switch.

- Traffic accessing Farrow Parkway to Market Commons or SC RT 707 to Socastee Boulevard will be detoured to the Palmetto Pointe Boulevard intersection. The public is also encouraged to utilize Harrelson Boulevard, US RT 17 Business, and SC RT 544 to access Market Commons/Farrow Parkway.
- Several electronic message boards and signage will be located at the intersection advising motorists of the detours and several patrol officers will be located at the intersection to ensure safety during this 24-hour period.
- *Construction schedule is attached.*

###

Updated US17 Bypass/SC707 Interchange Construction Stages

Stage 1 – June 2011 – September 2011

- Install temporary and permanent drainage.
- Construct temporary pavement in median on south end of the project.
- Construct the Temperance Connector.
- Construct Port Drive and Macklen Road to Watergate Drive.
- Install temporary shoring and temporary pavement along SC707.

Stage 2 – September 2011 – June 2012

- NB traffic is maintained in existing lanes with some minor shifts.
- NB traffic going to Farrow will use the Temperance Connector.
- Construct Ramps A & B.
- Construct permanent walls adjacent to NB lanes north and south of Farrow Pkwy.
- Tie Macklen road into SC707.
- Widen pavement on the inside of the SB lanes.

Stage 3 – June 2012 – October 2012

- NB traffic shifts to Ramps A & B.
- SB traffic shifts to existing NB lanes.
- Construct Ramps C & D.
- Reconstruct the pavement at the north end of Port Drive.
- Reconstruct the pavement at Palmetto Pointe Drive.

Stage 4 –October 2012 –October 2013

- SB traffic shifts to Ramps C & D.
- Construct bridge and approaches.

Stage 5 –October 2013 – January 2014

- US 17 traffic on new bridge.
- Final paving and restoration on Ramps B & D, Farrow Parkway and Socastee.

Stage 5A – January 2014 –March 2014

- Final paving on Ramps B & D and Farrow Pkwy.
- Construct SB u-turn.

Stage 6 – March 2014 – April 2014

- Final paving on Ramps B & D and Farrow Pkwy.

Stage 7 – May 2014 – July 2014

- Final paving Ramps A & C, Farrow Parkway and Socastee.

Stage 7A – July 2014 – August 2014

- Remove temporary pavement and temporary drainage.
- Final paving Ramps A & C, Spur C, Farrow Parkway and Temperance Connector.

Updated 05.21.12

PROPOSED DETOUR MAP
US 17 BYPASS NB/SB LEFT TURNS ONTO
SC 707/FARROW PARKWAY

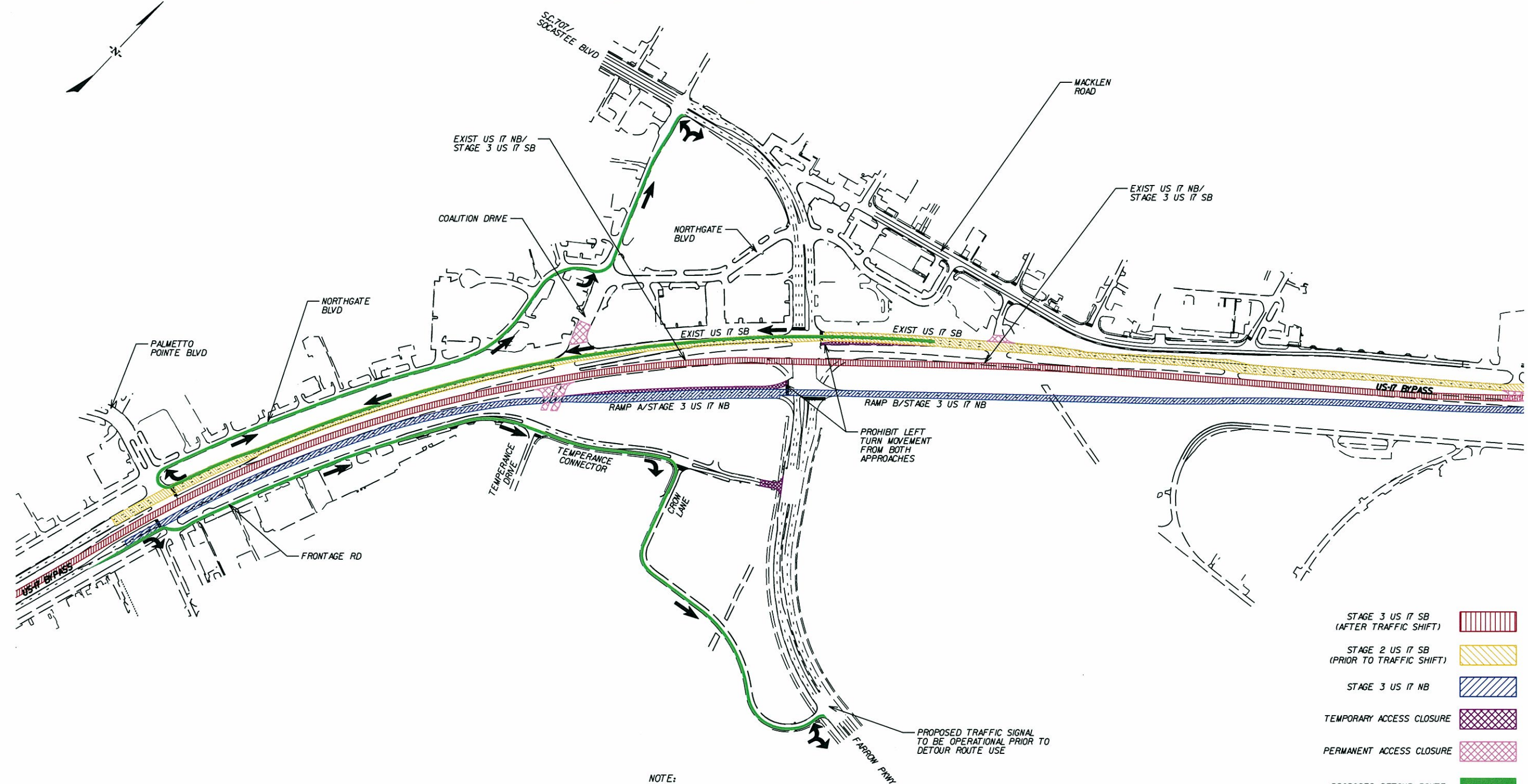

- STAGE 3 US 17 SB (AFTER TRAFFIC SHIFT)
- STAGE 2 US 17 SB (PRIOR TO TRAFFIC SHIFT)
- STAGE 3 US 17 NB
- TEMPORARY ACCESS CLOSURE
- PERMANENT ACCESS CLOSURE
- PROPOSED DETOUR ROUTE

NOTE:
CHANGEABLE MESSAGE SIGNS SHALL BE UTILIZED AND PLACED IN A LOCATION AS TO PROPERLY PREPARE DRIVERS FOR THE PROPOSED TRAFFIC SHIFT.
DETOUR ROUTE SIGNS SHALL BE UTILIZED ALONG EACH DETOUR TO GUIDE DRIVERS TO THE CORRECT DESTINATION.
TEMPORARY CLOSURES WILL ADHERE TO SC STANDARD DRAWINGS FOR TEMPORARY ROAD CLOSURES.
REFER TO PLAN SET SHEET TC-111 FOR PROJECT REQUIREMENTS.

FOR INFORMATION ONLY

STV Incorporated
ROCK HILL BUSINESS TECHNOLOGY CENTER, BTC 517
454 S. ANDERSON ROAD, SUITE 3
ROCK HILL, SOUTH CAROLINA 29720

SOUTH CAROLINA
DEPARTMENT OF TRANSPORTATION
ROAD DESIGN COLUMBIA, S.C.

**INTERCHANGE AT US 17 BYPASS
AND SC 707 / FARROW PARKWAY
PROPOSED DETOUR ROUTE MAP
US 17 TRAFFIC SWITCH**

SCALE 1"=400 RTE. US 17 BYPASS DWG.NO. PN1

